



Mahlkönig Sync

Mobile Application

Table of Contents

Pre-Requisites! **3**

Customer Roles **4**

Creating an Account & Log-in **5**

User Profile & Data Privacy **6**

Mahlkönig Resources **7**

Onboarding GbS to Wifi & Mahlkönig Sync Cloud **8**

Syncing Machine to Mahlkönig Sync App & GbS Grinder **14**

Syncing existing machine to GbS Grinder **16**

Unsyncing Machine from Mahlkönig Sync App & GbS Grinder **17**

Device Menus **21**

Accessing Analytics **22**

Pre-Requisites!

To be able to onboard a GbS grinder
you need a GbS grinder

•

Users not having a GbS grinder will only see part
of the functionality in the apps. The apps are centered around
monitoring statistics, telemetry, and more on the devices

•

To be able to Sync a GbS to a La Marzocco machine,
you need a La Marzocco Coffee Machine with ABR system

•

You also need the La Marzocco app and you need to
make sure that the La Marzocco machine is already onboarded
according to La Marzocco's own onboarding instructions.

•

The grinder uses the modern 5Ghz Wifi protocol and will ONLY
capture 5Ghz. Old 2.4Ghz networks are not supported.

Customer Roles

Company Manager: The person with overall responsibility of assets across a company

- Can invite and edit regional managers, store managers, baristas
- Can onboard edit devices across the company
- Can define company regions and stores

•

Regional Manager: The person with oversight across a specific region

- Can invite and edit store managers, baristas
- Can onboard edit devices across the region of responsibility
- Can define stores

•

Store Manager: The person responsible for a given store

- Can invite and edit baristas
- Can onboard edit devices for her/his store

•

Barista: The person usually operating the equipment

- Can view data for the defined store

//

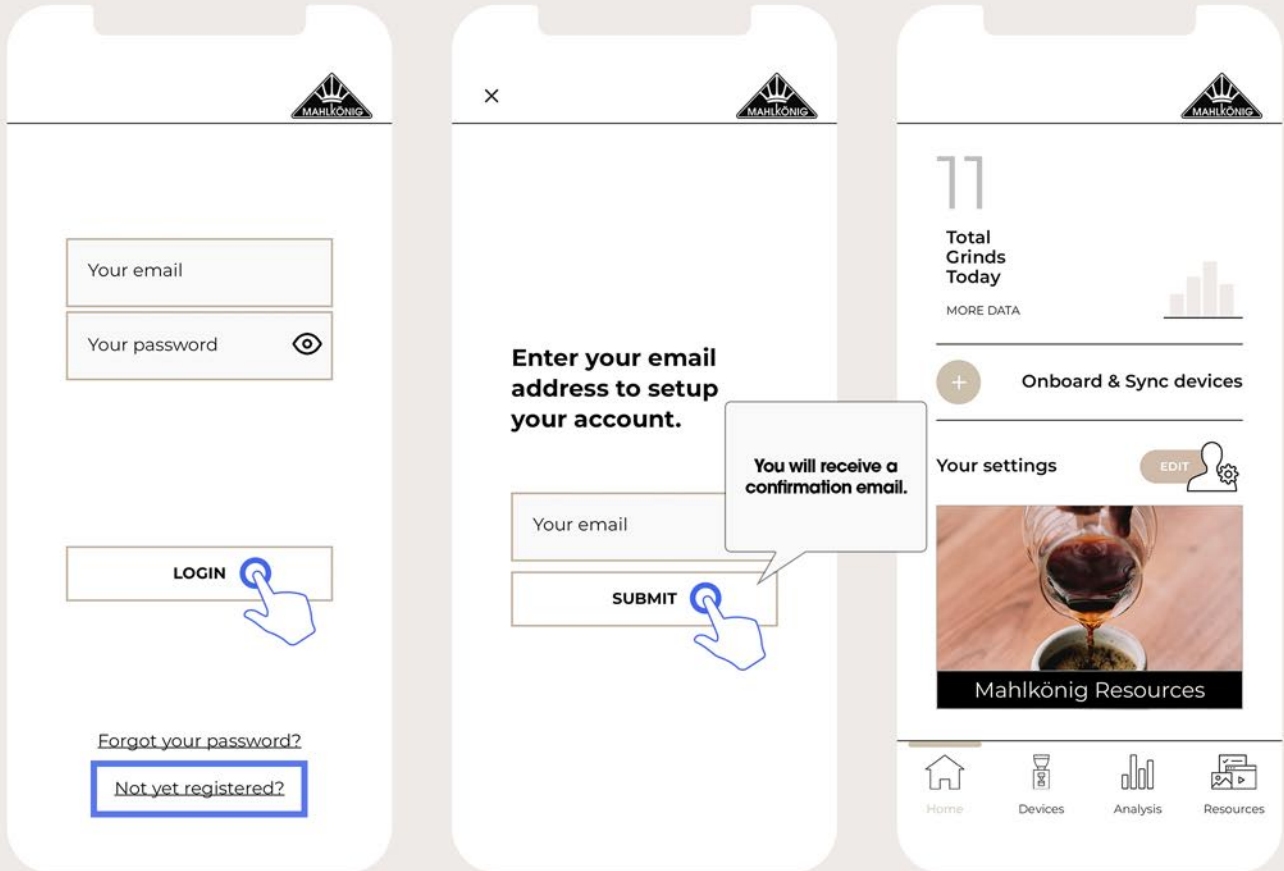

Creating an Account & Log-in

Available in mid-April
on iOS & Android

//

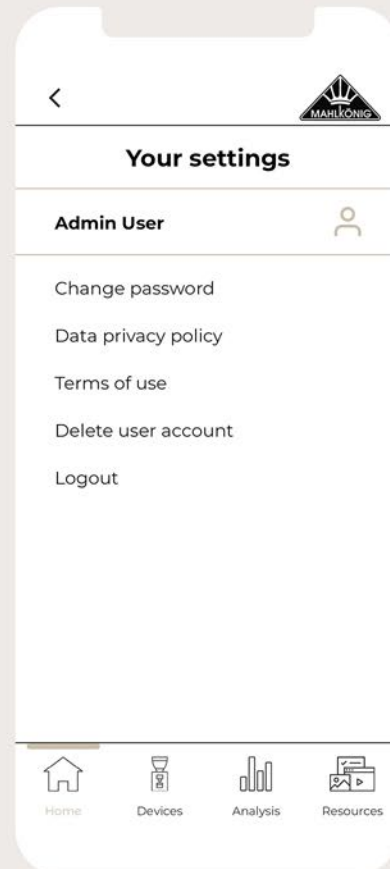
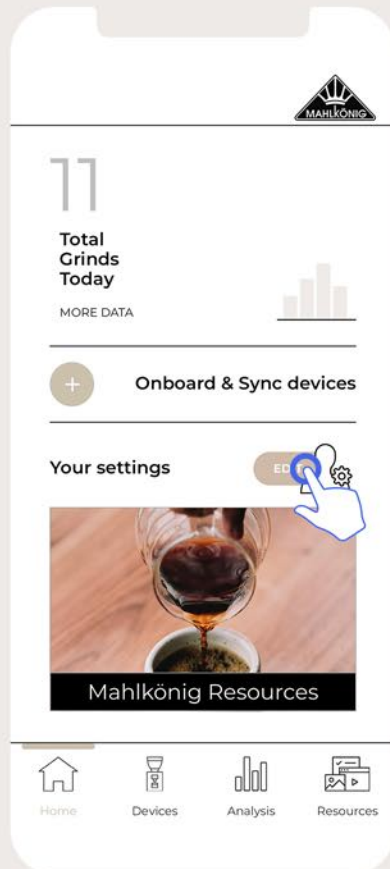

User Profile & Data Privacy

//

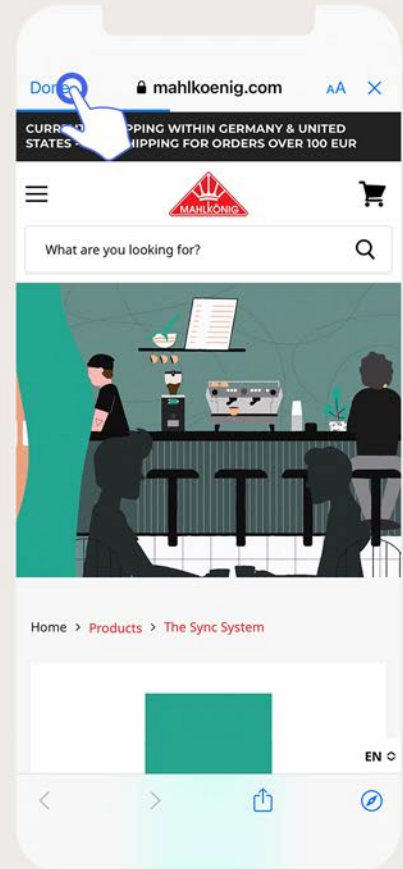
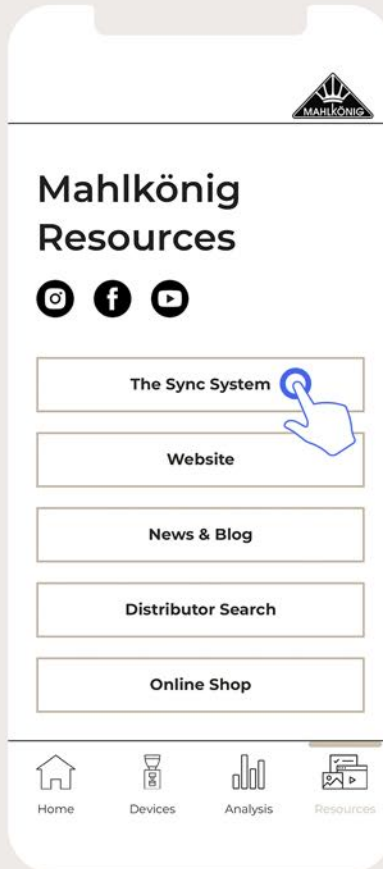
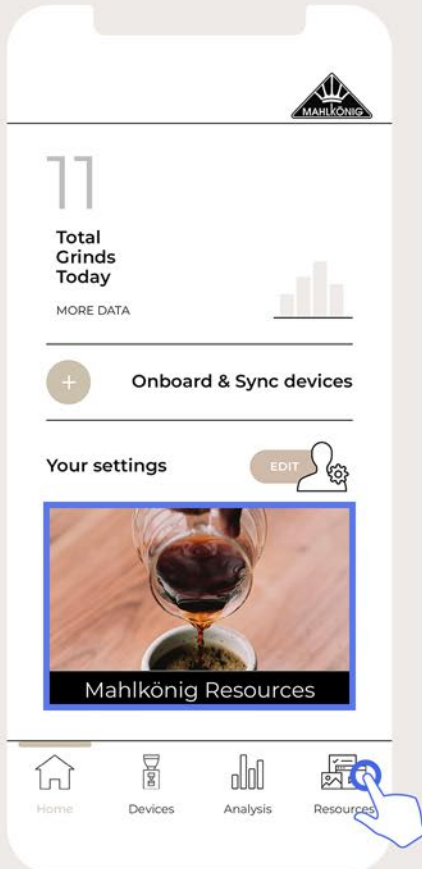

Mahlkönig Resources

//

01 Click the extended menu (burger symbol, bottom left button) from the main menu.

02 Browse using the knob to "User Mgmt" and log in as Owner.
Password = 1942

03 After logging-in, and coming back up a level, you will now see the "Connectivity" menu. Select this with a click on the large knob.

04 Select "Cloud Settings" and enable everything under this menu if not already the case

Onboarding GbS to Wifi & Mahlkönig Sync Cloud

To onboard the grinder, follow these steps on the grinder

//

05 Select "Wifi Settings"

06 Select "Enable Wifi"
(after this selection,
browse lower on the
same screen and
check that your Wifi is
on Access point
mode, if not, click on
"Reset Wifi")

07 Select "Quick
Connect", which will
then show the
QR-Code

08 To onboard to Wifi
and to the Cloud,
follow the steps on the
next slide

Onboarding GbS to Wifi & Mahlkönig Sync Cloud

To onboard the grinder, follow these steps on the grinder

//

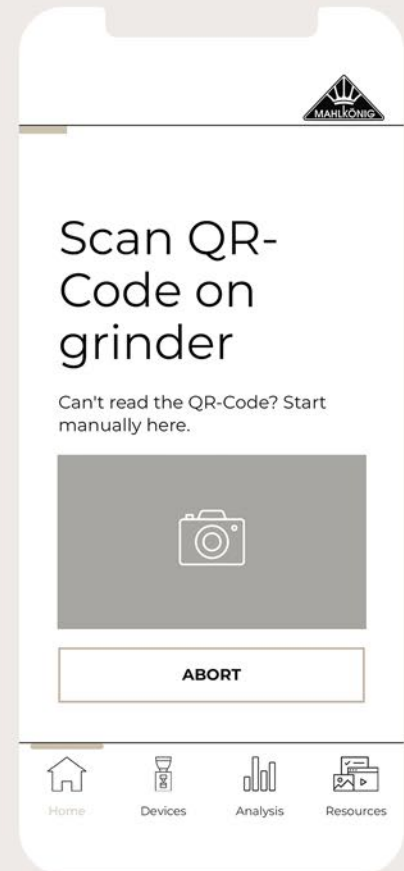
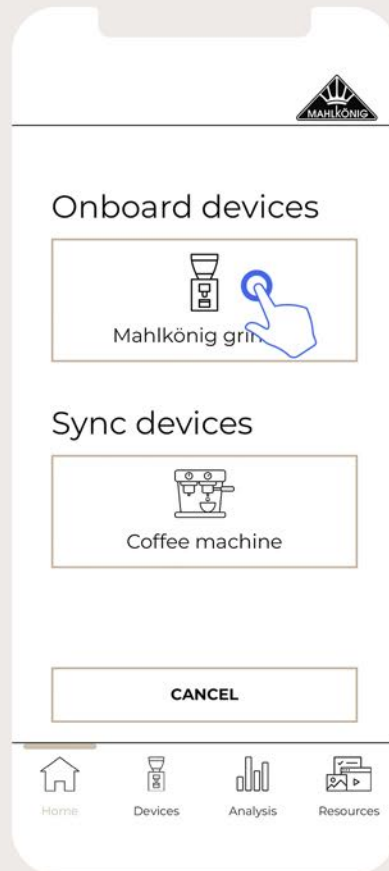
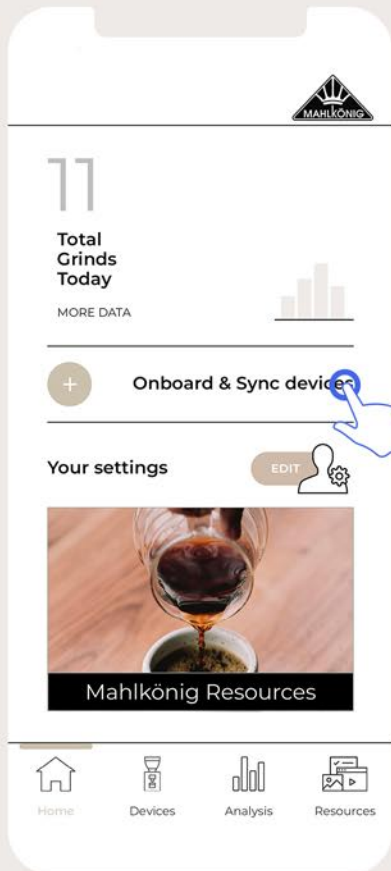

Onboarding GbS to Wifi & Mahlkönig Sync Cloud

//

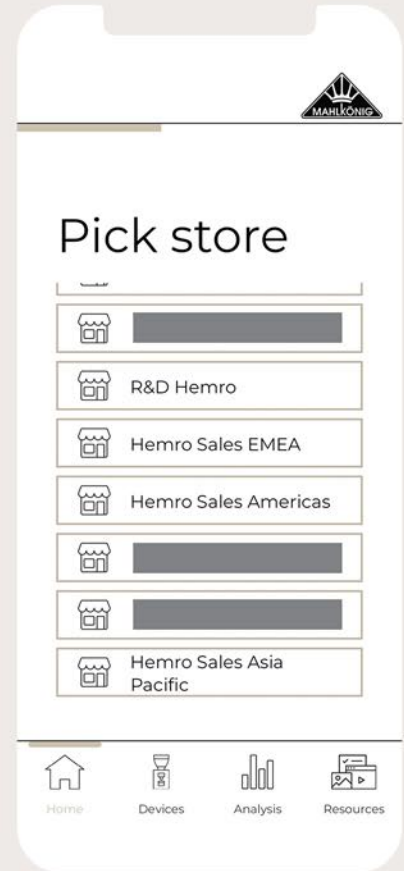
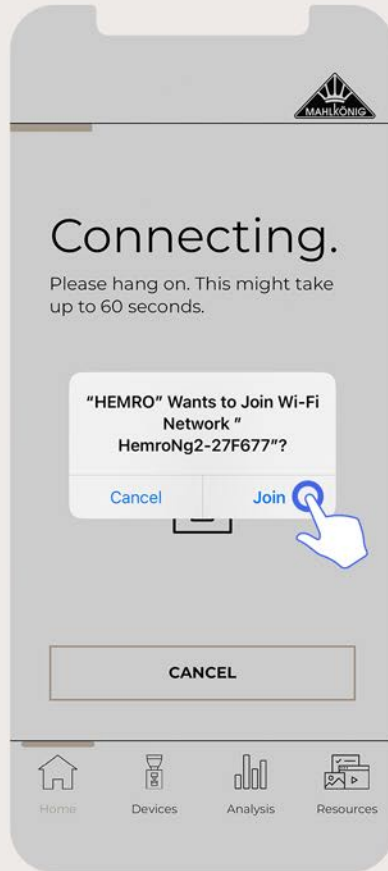
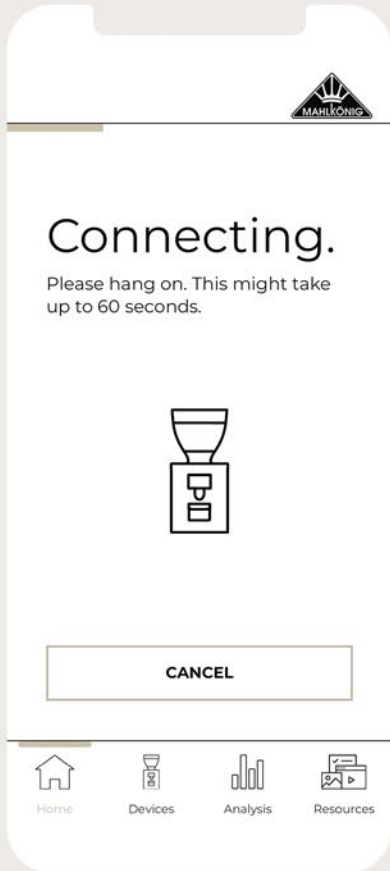

Onboarding GbS to Wifi & Mahlkönig Sync Cloud

//

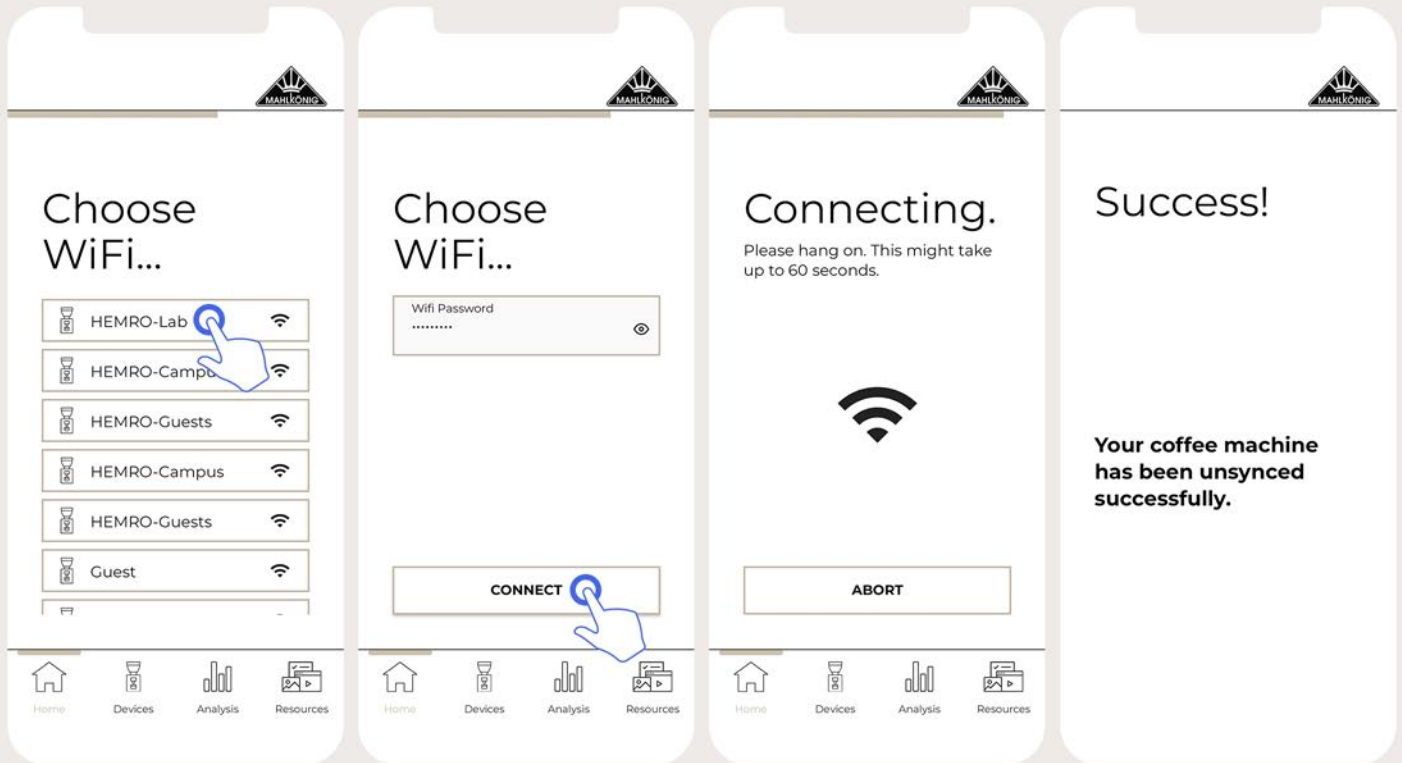

Onboarding GbS to Wifi & Mahlkönig Sync Cloud

//

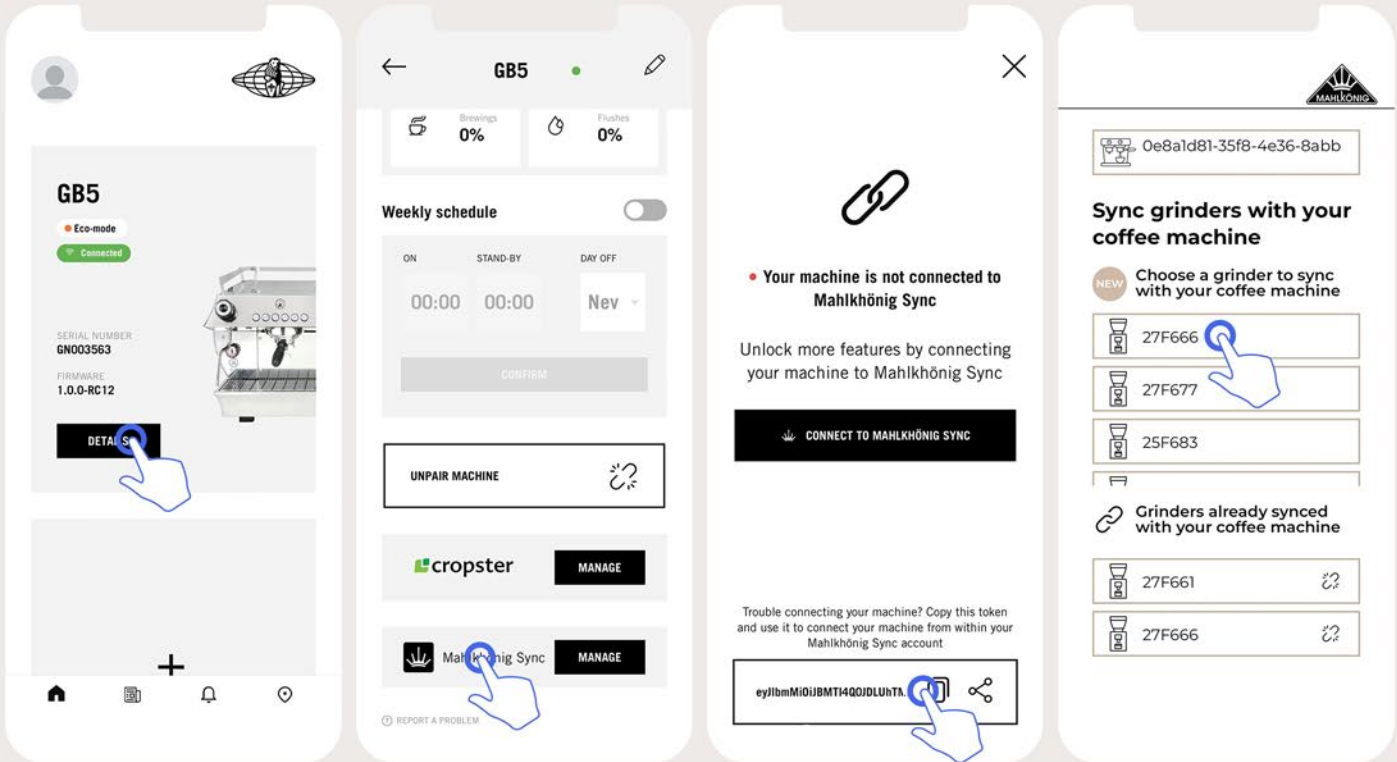

Syncing Machine to Mahlkönig Sync App & GbS Grinder

Starting from the
La Marzocco App

//

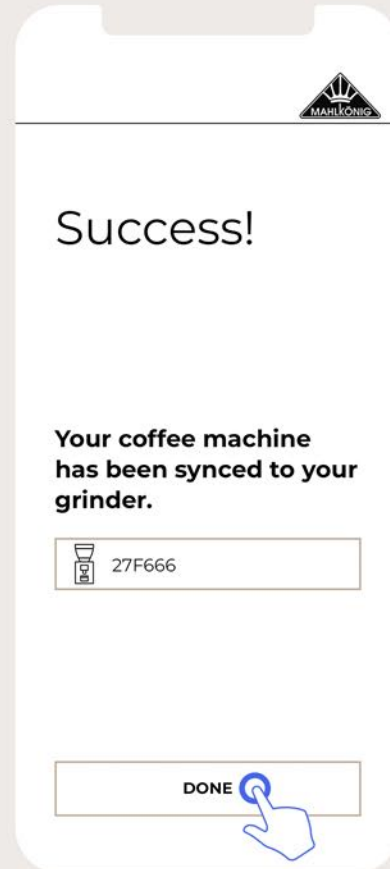
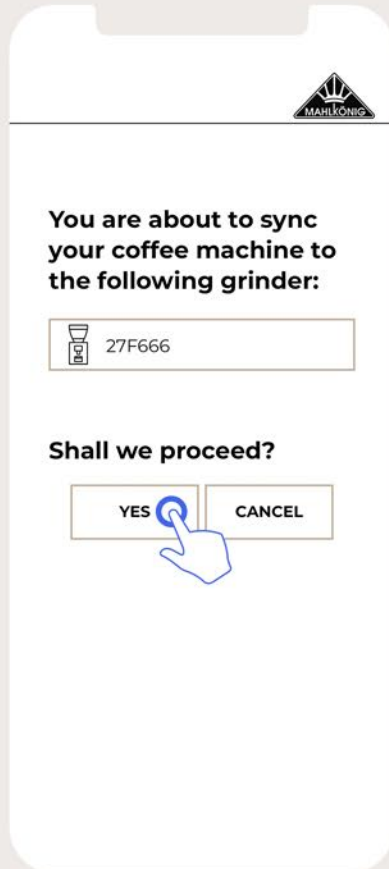

Synching Machine to Mahlkönig Sync App & GbS Grinder

Starting from the
La Marzocco App

//

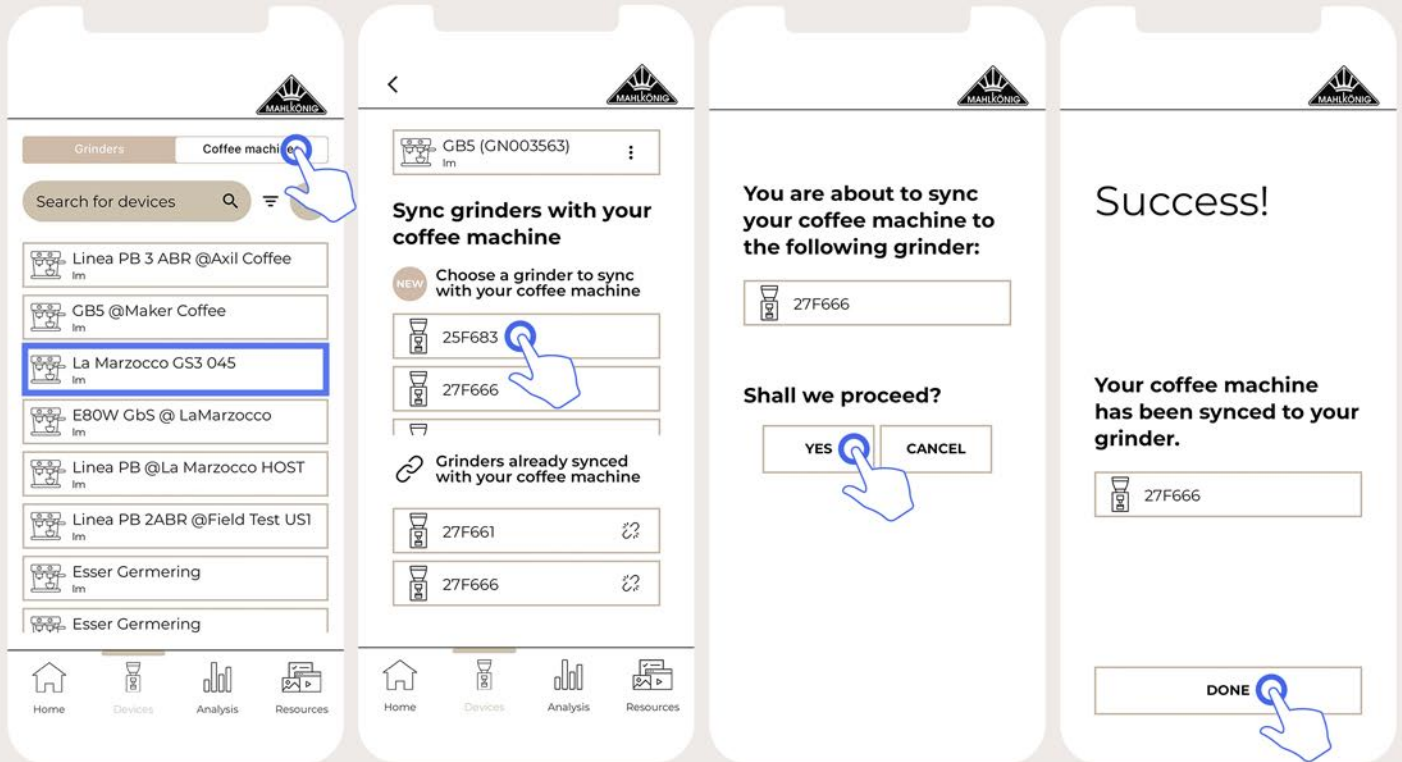

Syncing Existing Machine to GbS Grinder

//

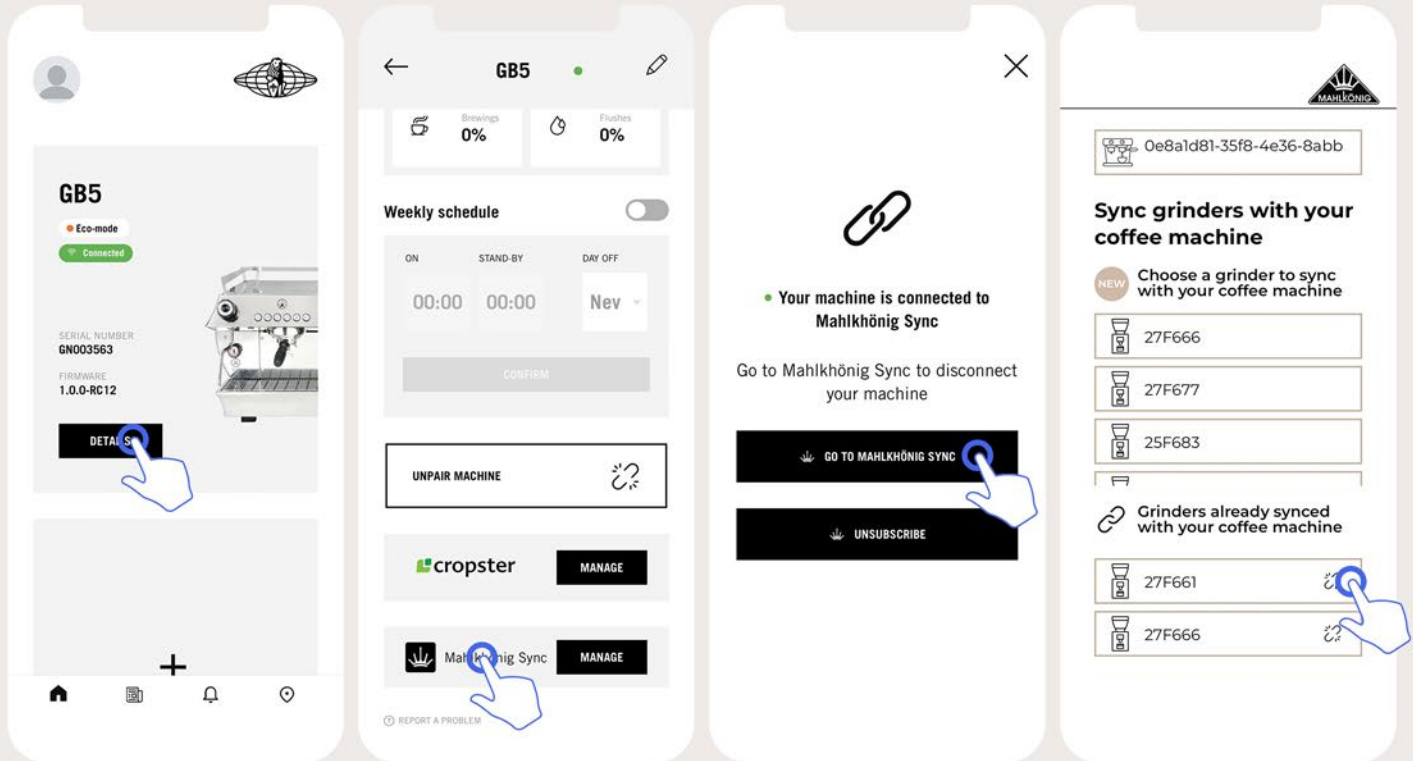

Unsyncing Machine from Mahlkönig Sync App & GbS Grinder

Starting from the
La Marzocco App

//

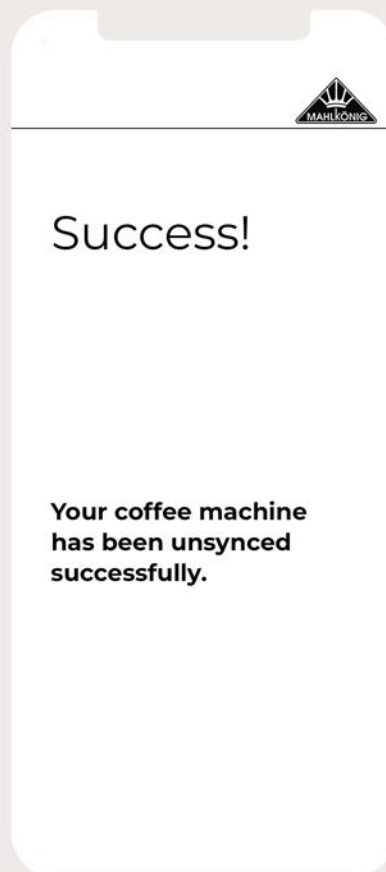

Unsyncing Machine from Mahlkönig Sync App & GbS Grinder

Starting from the
La Marzocco App

//

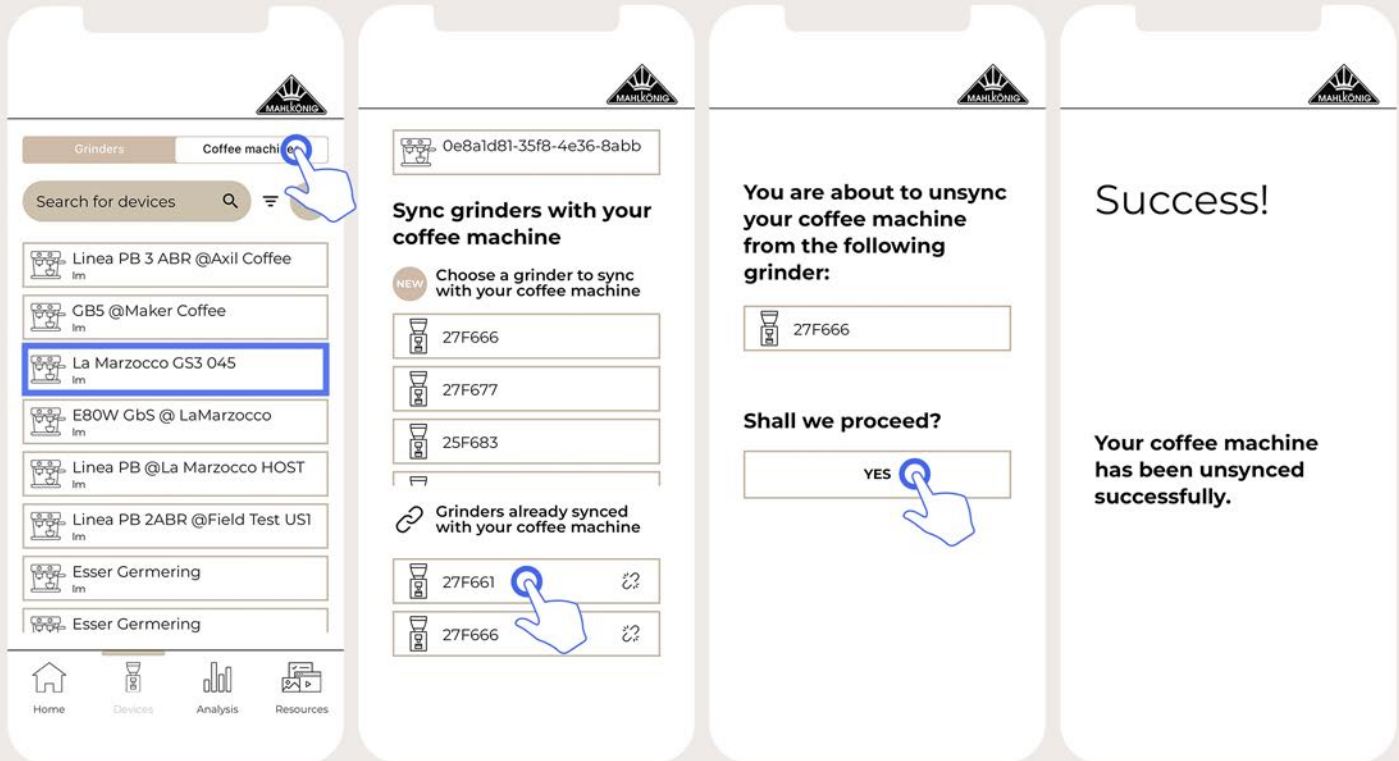

Unsyncing Machine from Mahlkönig Sync App & GbS Grinder

Starting from the
La Marzocco App

//

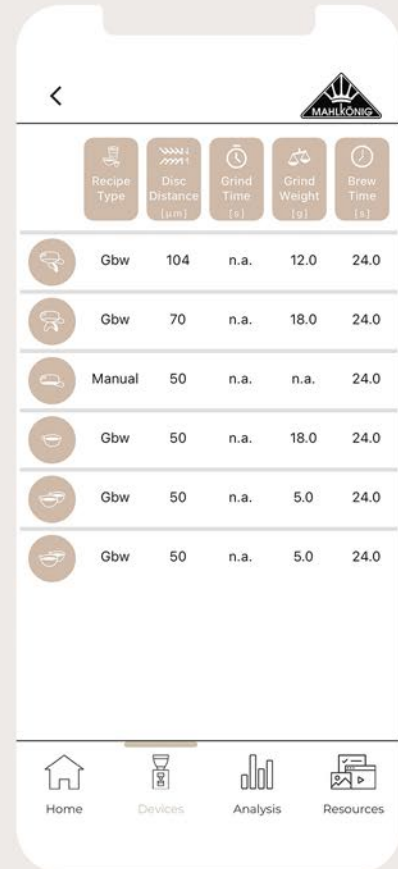
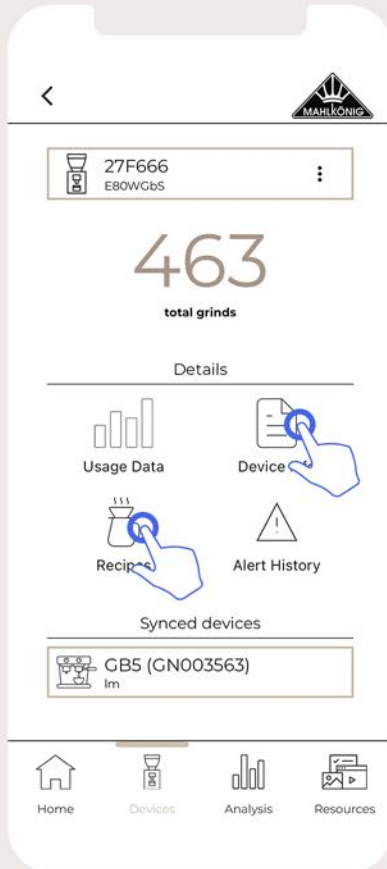

Device Menus

//

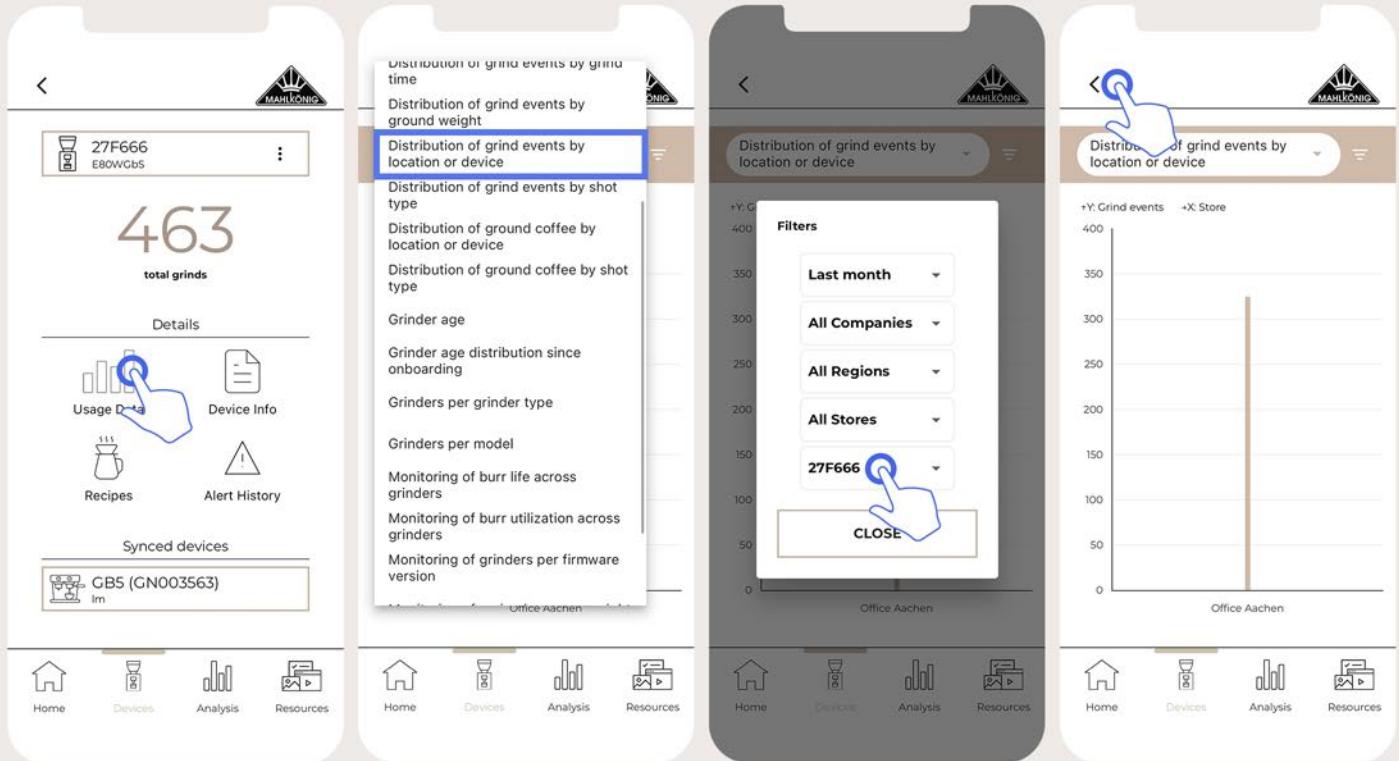

Accessing Analytics

//

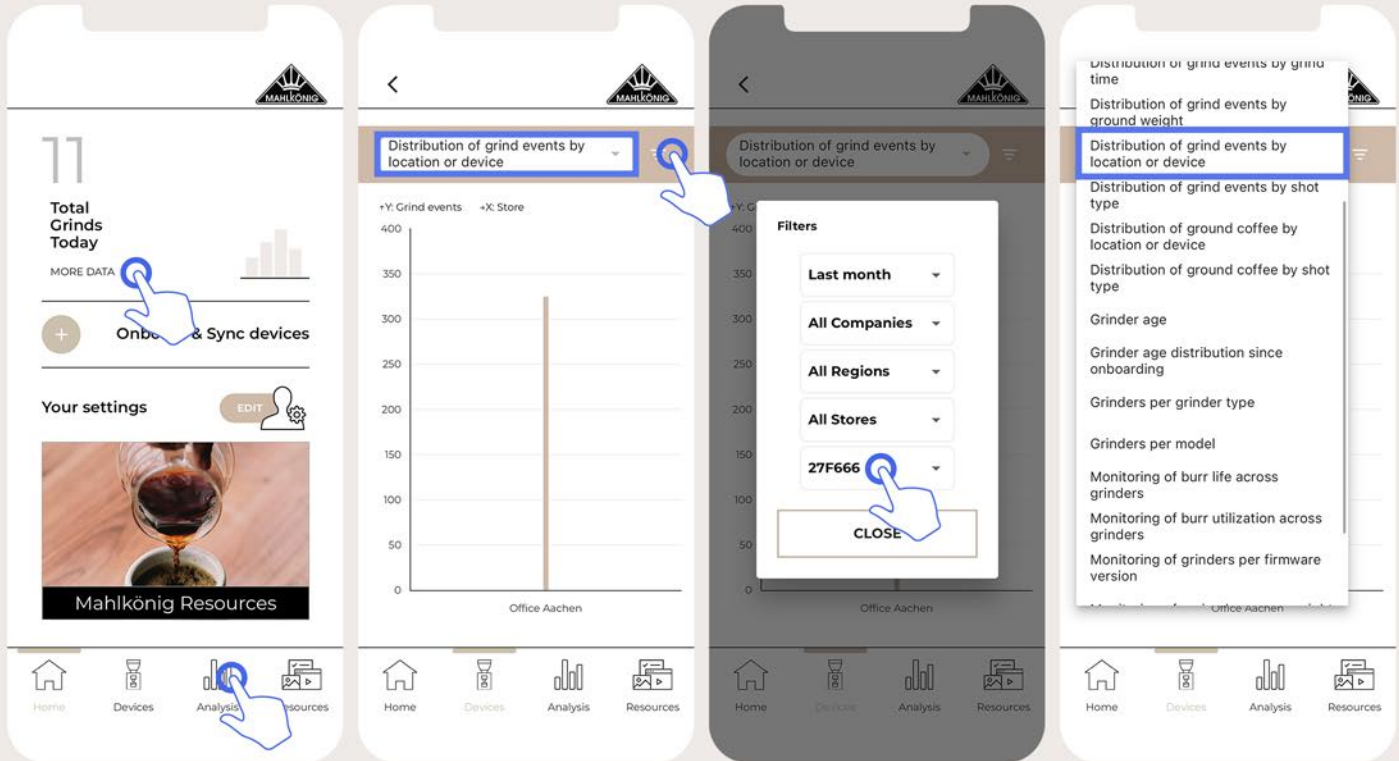

Accessing Analytics

